

# SPLENDIDO

A BELMOND HOTEL  
PORTOFINO

*The radiant stage of Portofino*





## OUR HOTEL

Perched on the hillside overlooking Portofino harbour, Splendido offers breathtaking views of the Italian Riviera. An enduring symbol of La Dolce Vita, the hotel boasts glamorous rooms and suites renovated by architect Martin Brudnizki. A new Dior Spa, fitness centre, lush gardens, iconic saltwater pool, and three panoramic F&B establishments - including our fine dining restaurant, La Terrazza - complete the offering. Guests can enjoy authentic cuisine, a range of complimentary weekly activities, shuttle runs down to the Piazzetta, and access to our sister property, Splendido Mare.

Indulge in the local lifestyle with our exclusive experiences, such as romantic sunset cruises aboard our private boat and olive oil tasting on the picturesque terrace.

## AT A GLANCE

### ACCOMMODATION

Choose from 52 beautifully furnished rooms and suites, many with private terraces looking out on enchanting panoramas. Connecting rooms are available on request.

### WINING & DINING

One fine-dining restaurant, one casual restaurant and one fully-refurbished fine bar - all overlooking the Gulf of Portofino.

### FEATURES

Panoramic saltwater swimming pool, Dior Spa, Jardin des Rêves Dior, courtesy shuttle to the Piazzetta, fitness centre, tennis court, boutique and more.

### LOCATION

Portofino, 45 minutes by car from Genoa International Airport (GOA).

## UNIQUE SELLING POINTS

- Prime location in the protected park of Portofino just 15 minutes walking from the vibrant Piazzetta, with jaw-dropping views of the Gulf of Tigullio.
- A choice of two restaurants - the Splendido Grill by the pool, and the fine dining La Terrazza - and one renovated signature bar.
- A new Dior Spa where guests can indulge in Dior's expertise and holistic treatments, as well as relax on the rooftop, and the Jardin Des Rêves Dior, nestled in the heart of the hotel's gardens.

## IDEAL FOR

Families  
Wellness & Spa  
Adventure & Sports  
Cultural & Historical Exploration  
Nature Immersion  
Romance & Honeymoon  
Art, Design & Shopping  
Gastronomy  
Long stay  
Journeys

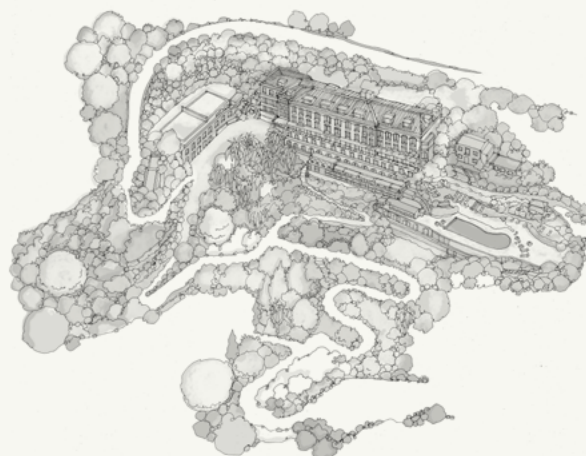
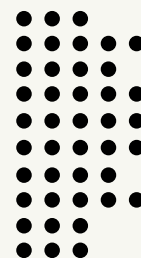

**SPLENDIDO, SALITA BARATTA 16, 16034 PORTOFINO,  
GENOA, ITALY**





## ACCOMMODATION

### SIGNATURE SUITES & VILLAS

#### LA DOLCE VITA SUITE (1)

**SIZE: 91 SQ M (980 SQ FT)**

**+ PRIVATE GARDEN 30 SQ M (323 SQ FT)**

Located on the tranquil hillside away from the main hotel building, this suite offers total privacy and an elegant sitting area.

1 bedroom / Sleep 5 (two single sofa beds are already included and an extra bed can be added)

No connecting rooms available.

#### Key Features:

Unparalleled views of the Portofino Bay • 30 sq m private garden • Private access • Two marble bathrooms, one with separate shower, bathtub and double basins.

#### BARONESSA SUITE (1)

**SIZE: 60 SQ M (646 SQ FT)**

**TERRACE SIZE: 44 SQ M (474 SQ FT)**

Inspired by the splendid palazzos of the region, this suite blends rich tradition with lavish comfort. 1 bedroom / Sleep 3 (one extra bed can be added)

Can connect to the Prestige Suite.

#### Key Features:

Unparalleled views of the Portofino Bay • Curated antiques and objects, such as painted Genovese bedside tables topped by Albisola table lamps • A private-entrance garden with direct access to the hotel's pool • Furbished terrace

#### SAN GIORGIO SUITE (1)

**SIZE: 70 SQ M (750 SQ FT)**

Named after Portofino's patron saint, this newly-designed suite is inspired by both the monastic character of the Splendido building and the cultural heritage of the fisherman's church.

1 bedroom / Sleep 3 (a rollaway bed can be added)

Connecting to a Premium Room.

#### Key Features:

Pared-back elegance meets carved marble, graniglia flooring and painted ceiling details • Furnished balcony with views of the Portofino Bay and San Giorgio church tower • A wrap around terrace embraces the master bedroom.

#### ALL SIGNATURE SUITES AND VILLAS INCLUDE

Round-trip transfers • Dedicated Host service • Daily breakfast • Complimentary laundry service •

Complimentary curated in-suite bar and coffee • A fully bespoke VIP stay experience, tailored to your preferences



## ACCOMMODATION

### ROOMS & SUITES

#### GARDEN VIEW ROOM (4)

**AVERAGE SIZE: 25 SQ M (270 SQ FT)**

1 bedroom / Sleeps 2 (no extra beds)

Can connect with a double room and a junior suite.

#### PREMIUM ROOM (4)

**AVERAGE SIZE: 40-50 SQ M (430-535 SQ FT)**

1 bedroom / Sleeps 2 (no extra beds)

Can connect with Prestige Suite, Smeraldo Junior Suite and San Giorgio Suite.

#### BARATTA JUNIOR SUITE (1)

**SIZE: 54 SQ M (580 SQ FT)**

1 bedroom / Sleeps 3 (a rollaway bed can be added)

#### GLICINE JUNIOR SUITE (3)

**AVERAGE SIZE: 50 SQ M (535 SQ FT)**

1 bedroom / Sleeps 3 (a rollaway bed can be added)

Can connect with Glicine Suite

#### PRESTIGE JUNIOR SUITE (7)

**AVERAGE SIZE: 45 SQ M (480 SQ FT)**

1 bedroom / Sleeps 2 (no extra beds)

Can connect with Riviera Suite and Smeraldo Junior Suite

#### SPLENDIDO JUNIOR SUITE (8)

**AVERAGE SIZE: 50 SQ M (535 SQ FT)**

1 bedroom / Sleeps 3 (a rollaway bed can be added)

Two junior suites can connect with each other

#### SMERALDO JUNIOR SUITE (6)

**AVERAGE SIZE: 60 SQ M (645 SQ FT)**

1 bedroom / Sleeps 3 (a rollaway bed can be added)

Can connect with Prestige Junior Suite

#### SEA VIEW SUITE (1)

**AVERAGE SIZE: 62 SQ M (665 SQ FT)**

1 bedroom / Sleeps 3 (a rollaway bed can be added)

#### GLICINE SUITE (3)

**AVERAGE SIZE: 65-80 SQ M (700-860 SQ FT)**

1 bedroom / Sleeps 3 (a rollaway bed can be added)

Can connect Splendido Junior Suite

#### PORTOFINO SUITE (3)

**AVERAGE SIZE: 70 SQ M (750 SQ FT)**

1 bedroom / Sleeps 4 (a rollaway and sofa bed can be added)

#### PRESTIGE SUITE (6)

**AVERAGE SIZE: 55-75 SQ M (590-800 SQ FT)**

1 bedroom / Sleeps 3 (a rollaway bed can be added)

Can connect with Baronessa Suite and Premium Room

#### RIVIERA SUITE (3)

**AVERAGE SIZE: 75-105 SQ M (800-1130 SQ FT)**

1 bedroom / Sleeps 4 (a rollaway and sofa bed can be added)

Some suites can connect with Prestige Junior Suite

#### ALL ACCOMMODATION INCLUDES

Air conditioning • 24-hour room service • In-room bar with complimentary soft drinks • Complimentary Wi-Fi • Twice-daily housekeeping service • Satellite TV • Press Reader with over 3,000 periodicals in 18 languages • Courtesy line by Acqua di Parma • Nespresso machine



## RESTAURANT & BARS / FEATURES



### RESTAURANT & BARS

#### LA TERRAZZA

Fine dining cuisine offering Italian and regional specialities. Breakfast 07:30-11:00; lunch 13:00-14:15; dinner 19:30- 22:15.

#### SPLENDIDO GRILL

Casual daytime dining experience featuring Italian classics, elegant fine dining atmosphere in the evening with fire-inspired cuisine.

Lunch. 12:30-15:45 Dinner: 19:30-22:15.

#### LA TERRAZZA BAR

Fully-refurbished fine bar. Be entertained by live piano music from 19:00 to midnight. Open 10:00-01:00.

#### CHAMPAGNE GARDEN

An open-air terrace in the lush gardens overlooking the Bay of Portofino. The perfect spot to enjoy an aperitif or a glass of chilled champagne.

### FEATURES

#### FITNESS CENTRE

Work out on the latest gym equipment in our panoramic fitness centre.

#### TENNIS COURT

Enjoy a game on our all-weather court, set on the hillside. A professional coach is available for an extra charge. Complimentary access upon reservation, from 10:00 to sunset.

#### DIOR SPA - JARDIN DES RÊVES

A brand-new Dior Spa awaits with a full treatment menu that draws on the skills and expertise of Dior skincare. Or relax under the Italian sun at Jardin des Rêves Dior, a secluded corner for open-air massages in the hotel's fragrant gardens. Open daily from 10:00 to 20:00.

#### SIGNATURE BOUTIQUE

Browse exclusively designed clothing and chic accessories at our boutique.

Open 09:30-12:30 / 15:30-19:30

#### PRIVATE BOAT

Set off on an adventure around the Tigullian Gulf aboard our private Chris-Craft Corsair 36 motorboat.

#### GOLF

Play 18 scenic holes at Golf Club Rapallo, just 25 minutes' drive from the hotel.

#### FAMILY FUN

Our hotel is ideal for family stays. We provide children's bathrobes, slippers, and bottle warmers in your room. Extra beds and baby cots are available in Junior Suites and Suites. Our restaurants offer children's menus and highchairs. The Concierge desk can provide board games and a guidebook with family activities such as ice-cream tastings and pizza-making classes. Babysitting services are available upon request.

### COMPLIMENTARY SERVICES

- Heated, outdoor, saltwater swimming pool with shaded loungers and panoramic views. Towels provided. Low season: 09:00 - 18:00 / High season: 09:00 - 19:30
- Complimentary shuttle to the Piazzetta and Splendido Mare at scheduled times.
- Train in your accommodation or in the gardens by requesting the Technogym Case at reception. Download the Technogym app for a full range of workouts.
- Wide range of complimentary activities spanning from fitness like pilates classes, to foodie experiences and more.





## EXPERIENCES

### VISIT TO A LOCAL ECO FARM

Venture high onto the protected Mount of Portofino to visit the verdant grounds of a self-sufficient eco-farm. After exploring, enjoy a tasty picnic in a panoramic spot or taste local treats at a table prepared especially for you.

### NATURE WALKS

Venture on a wonderful walk to the secluded bay of San Fruttuoso, a place of unparalleled beauty that can be reached only on foot or by boat.

### SUNSET CRUISE AT SAN FRUTTUOSO BAY

Enjoy a refreshing apéritif on a Chris-Craft Corsair 36 speedboat at sunset in Portofino Bay. Depart at 17:30 to San Fruttuoso, savor canapés and chilled champagne on board, and return to Portofino by 19:00.

[Discover more experiences](#)

## OTHER RESOURCES



 Instagram

 Image Gallery

 BelmondPro

 Property Video

[Terms & Conditions](#)

[Register to our newsletter](#)

## FINER DETAILS

**CHECK IN: 15:00 CHECK OUT: 12:00**

### PET POLICY

Small pets are welcome in your accommodation. Pet bed and water bowl provided. Pets should not enter the pool, lobby, bar, restaurant, or beach areas and must be leashed in public spaces.

### EXTRA BEDS

Available on request for an additional fee.

### CHILDREN

Children up to 11 years old sharing a junior suite or suite with parents get a complimentary bed; meals are charged as taken.

### ACCESSIBILITY

Some outdoor areas or rooms may not be suitable for guests with restricted mobility due to the historic nature of our property. Speak to our team for any advice or assistance you may require.

# SPLENDIDO

A BELMOND HOTEL  
PORTOFINO

SPLENDIDO SALITA BARATTA 16, 16034 PORTOFINO, GENOA, ITALY  
T: +39 0185 2678 00 E: [RESERVATIONS.SPL@BELMOND.COM](mailto:RESERVATIONS.SPL@BELMOND.COM)  
[BELMOND.COM](http://BELMOND.COM)

INCOMPARABLE GENUINE TRAVEL

[BELMONDPRO.COM](http://BELMONDPRO.COM)