



SOUTHEAST ASIA



# FACT SHEET

The Eastern & Oriental Express travels one of the most magical and memorable routes in the world. This remarkable train, immaculately appointed and air-conditioned throughout, provides a perfect vantage point from which to view breathtaking scenery, meandering rivers and the lush tropical landscape of Southeast Asia.

## THE JOURNEY

All our journeys offer a unique opportunity to encounter fascinating people both on and off the train. Our journeys are about adventure, discovery and excitement.

Our **Classic Journeys** carry you in luxury from Singapore to Bangkok or vice versa.

Or choose one of our extended journeys, which venture into the Cameron Highlands and the jungles with our Fables of the Peninsula journey.

**SEASON: JANUARY - APRIL, SEPTEMBER - DECEMBER**

## JOURNEYS

### Classic Journeys

#### Bangkok—Singapore

(4 days & 3 nights)

*Highlights:* Bangkok, River Kwai, Kuala Kangsar, Singapore.

#### Singapore—Bangkok

(3 days & 2 nights)

*Highlights:* Singapore, Kuala Kangsar, River Kwai, Bangkok.

## WHAT'S INCLUDED

- All table d'hôte meals on board, which are a combination of Asian and European cuisine
- Complimentary tea and coffee in cabins
- Sightseeing tours as stated in itinerary
- 24-hour on-board service and entertainment
- On our Fables of the Peninsula journey house beverages are all-inclusive
- WiFi in the Observation Car and Presidential Cabins

## TYPICAL CAPACITY

Maximum number of guests 82

### TRAIN CONFIGURATION

<i>Restaurant Cars</i>	2
One with 28 seats, Saloon Car with 16 seats	
<i>Observation Car &amp; Bar</i>	1
<i>Bar Car</i>	1
<i>Cabins</i>	
Presidential Cabin (twin-beds)	2
State Cabin (twin-beds)	24
Pullman (upper & lower berths)	15
<i>Boutique</i>	1
<i>Saloon car (Lounge, Boutique, Small Restaurant)</i>	1



For reservations or further information please contact us, We look forward to hearing from you.

[WWW.BELMOND.COM/CONTACTUS](http://WWW.BELMOND.COM/CONTACTUS)



LIFE ON BOARD

**CABINS** The train offers three categories of elegant private cabins: Pullman Cabin, State Cabin and Presidential Cabin. All offer twin-sharing accommodation and are fully air-conditioned with en-suite shower and toilet.

The Pullman Cabins have upper and lower berths, while State Cabins and the Presidential Cabins offer two single beds at floor level. During the day, berths/single beds are converted into comfortable seating, so guests can relax and enjoy the magnificent landscapes. Presidential cabins also have a WiFi connection.

**DINING** There are three restaurant cars: “Adisorn”, “Rosaline” and “Malaya”—one of which joins the train for every journey. Each car is decorated in floral motifs reflecting the culture of the region. Menus offer delectable and innovative eastern and western fusion dishes created by our Executive Chef featuring local ingredients, providing the perfect dining experience.

**BOUTIQUE** Our signature boutique offers passengers the opportunity to purchase delightful mementos of their journey.

**SIGHTSEEING & EXCURSIONS** All sightseeing and excursions are escorted by expert guides, and are designed to provide the perfect balance of relaxation on board with the opportunity for inspiring experiences off the train.

**OBSERVATION CAR** Located at the end of the train with its own bar, this is the perfect place to enjoy cocktails amid a colonial “veranda” ambience with its teakwood flooring and panelled walls. There is also an outdoor observation area to enjoy the panoramic scenery and stunning sunsets. Complimentary WiFi is available for use in the Observation Car.

**SALOON CAR** This carriage contains a reading lounge, boutique and small restaurant. The reading room is a charming area offering a selection of books, magazines and games.

**PIANO BAR & ENTERTAINMENT** Located in the centre of the train, the piano bar is decorated with pale ash-wood panelling where a resident pianist entertains guests. Open all day and late into the night serving cocktails, aperitifs and liqueurs. Local entertainment can be enjoyed on selected evenings.

CABIN PLANS

Presidential Cabin

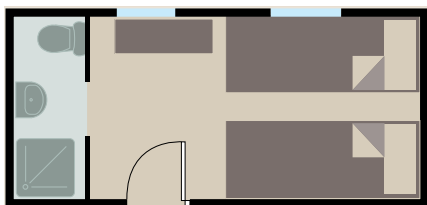

State Cabin

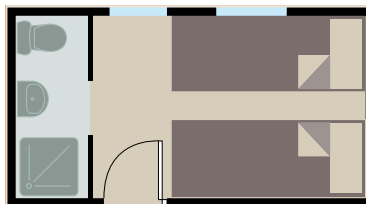

Pullman Cabin

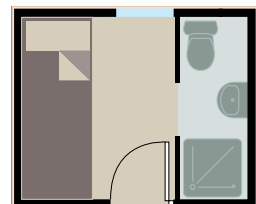

For reservations or further information please contact us, We look forward to hearing from you.

[WWW.BELMOND.COM/CONTACTUS](http://WWW.BELMOND.COM/CONTACTUS)



## SIGNATURE JOURNEYS

### Fables Of The Peninsula (7 days & 6 nights)

Explore the wonders of Southeast Asia on an extended journey that showcases the very best of peninsular Malaysia.

*Highlights include:*

- Singapore, Kuala Lumpur, Cameron Highlands tea plantation, Penang, Huay Yang a small fishing town and deserted island trip with swaying coconut palms, white beaches surrounded by majestic mountains

## EXTENSIONS

Our journeys are entirely flexible: enjoy a train journey on its own or extend the experience with a city break, beach resort or even a river cruise aboard Belmond Orcaella or Belmond Road to Mandalay to experience more of what Asia has to offer. We can build packages to all requirements including a stay at one of Asia's finest hotels, handpicked to complement your journey on the iconic train.

### BANGKOK

#### • Mandarin Oriental

Overlooking the Chao Phraya River, the hotel is world renowned for its impeccable service, luxurious accommodation, superb cuisine and legendary spa.

#### • The Peninsula

On the west bank of the Chao Phraya river, the hotel has 370 spacious and elegant guest rooms, a choice of restaurants, a three-tiered pool and an ESPA spa offering a wide range of treatments.

### SINGAPORE:

#### • Raffles Hotel

This famous, colonial style all-suite hotel has welcomed guests for over 100 years. The legendary Long Bar, with its famous Singapore Sling, the Raffles Grill, and the Amrita Spa all add to the luxurious ambience of your stay.

#### • The Shangri-La

Situated in the heart of the shopping district, this luxury hotel offers a wide choice of upscale restaurants and bars which complement the spacious rooms and public areas.

## THE ROUTE



*Routes shown are for guidance only and are subject to change*



For reservations or further information please contact us, We look forward to hearing from you.

[WWW.BELMOND.COM/CONTACTUS](http://WWW.BELMOND.COM/CONTACTUS)